

NEW YORK LADY

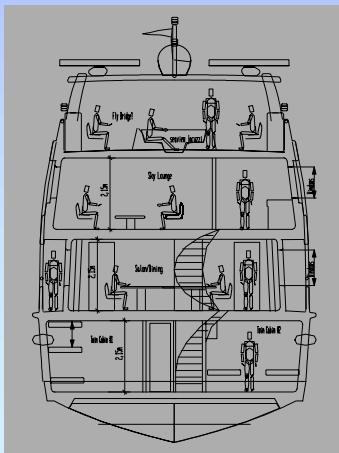
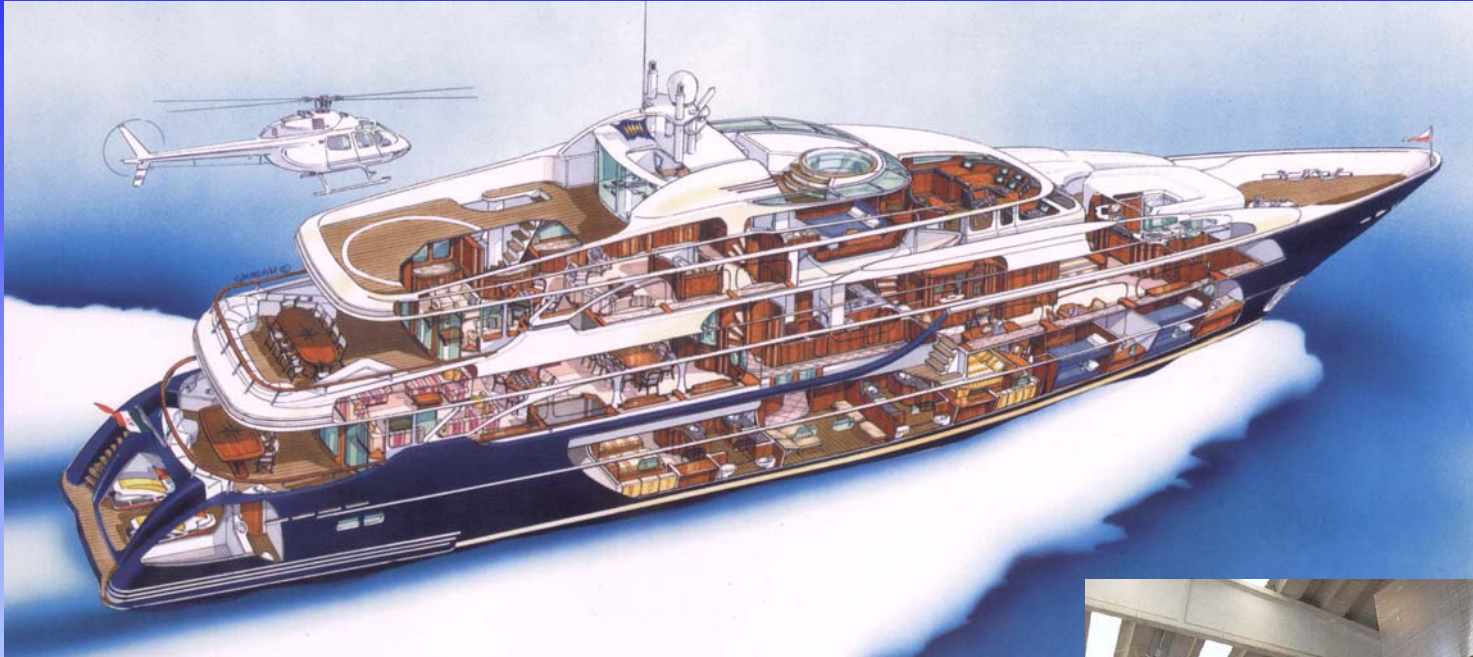

NEW YORK LADY: interior views

PRINCIPAL DIMENSIONS

LENGTH HULL	39.56m (129'9")
LENGTH O.A.	40.10m (131'6")
LENGTH W.L.	33.80m (110'11")
BEAM MOLDED	8.20m (26'11")

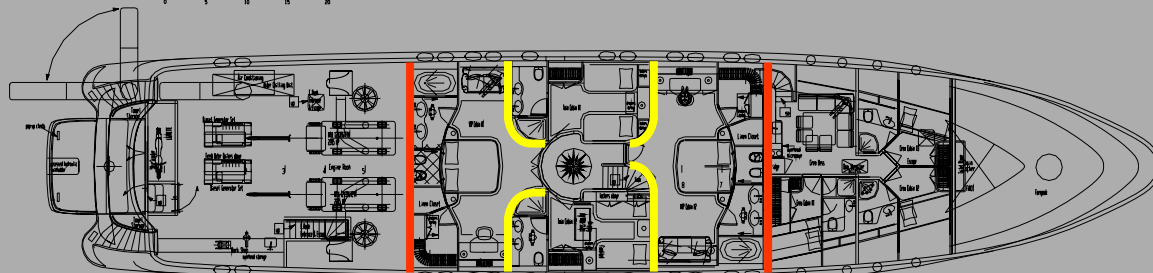
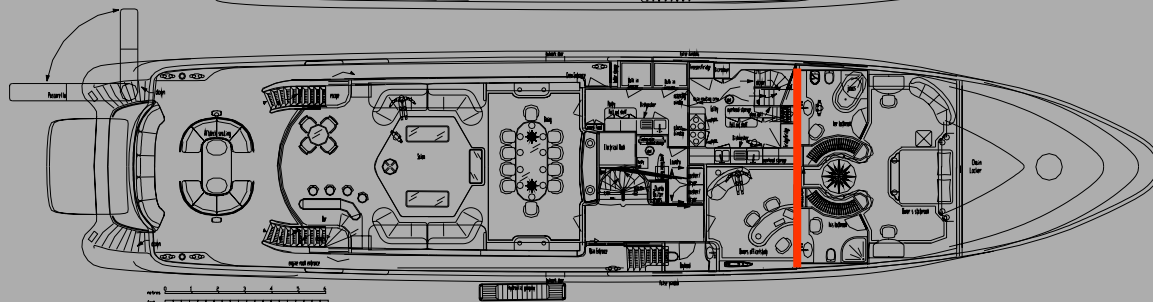
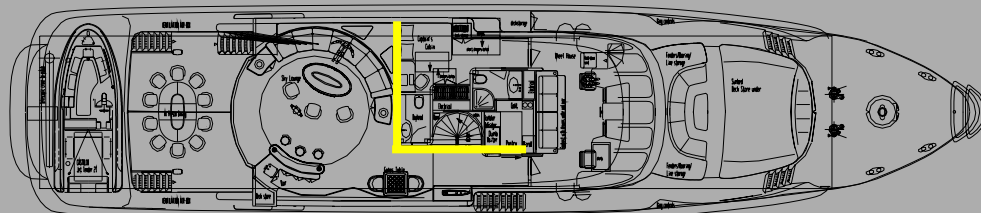
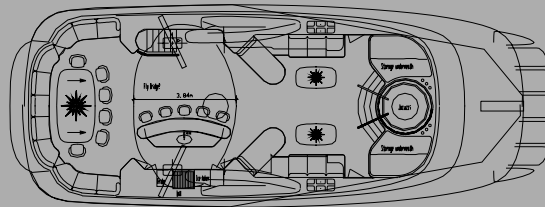

— structural wall

— high performance wall

MAXIMUM AXETTABLE LEVELS: at cruising speed of 17 Knots

Lower deck owner's stateroom	66 dB(A)
Guest cabins	66 dB(A)
Main deck saloon	66 dB(A)
VIP stateroom main deck	58 dB(A)
Sky lounge	60 dB(A)

NEW YORK LADY: walls and ceilings

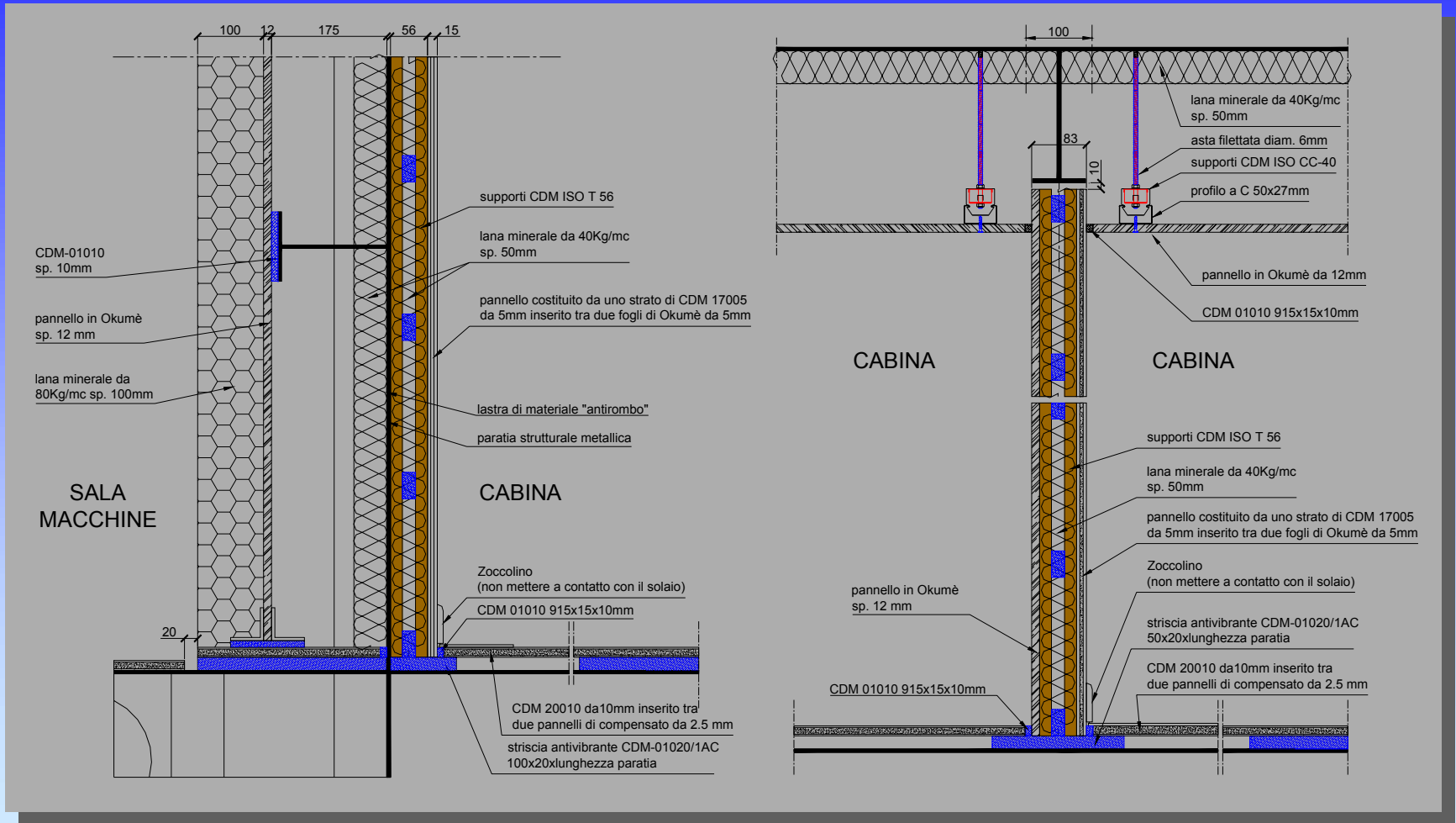

NEW YORK LADY: ceiling

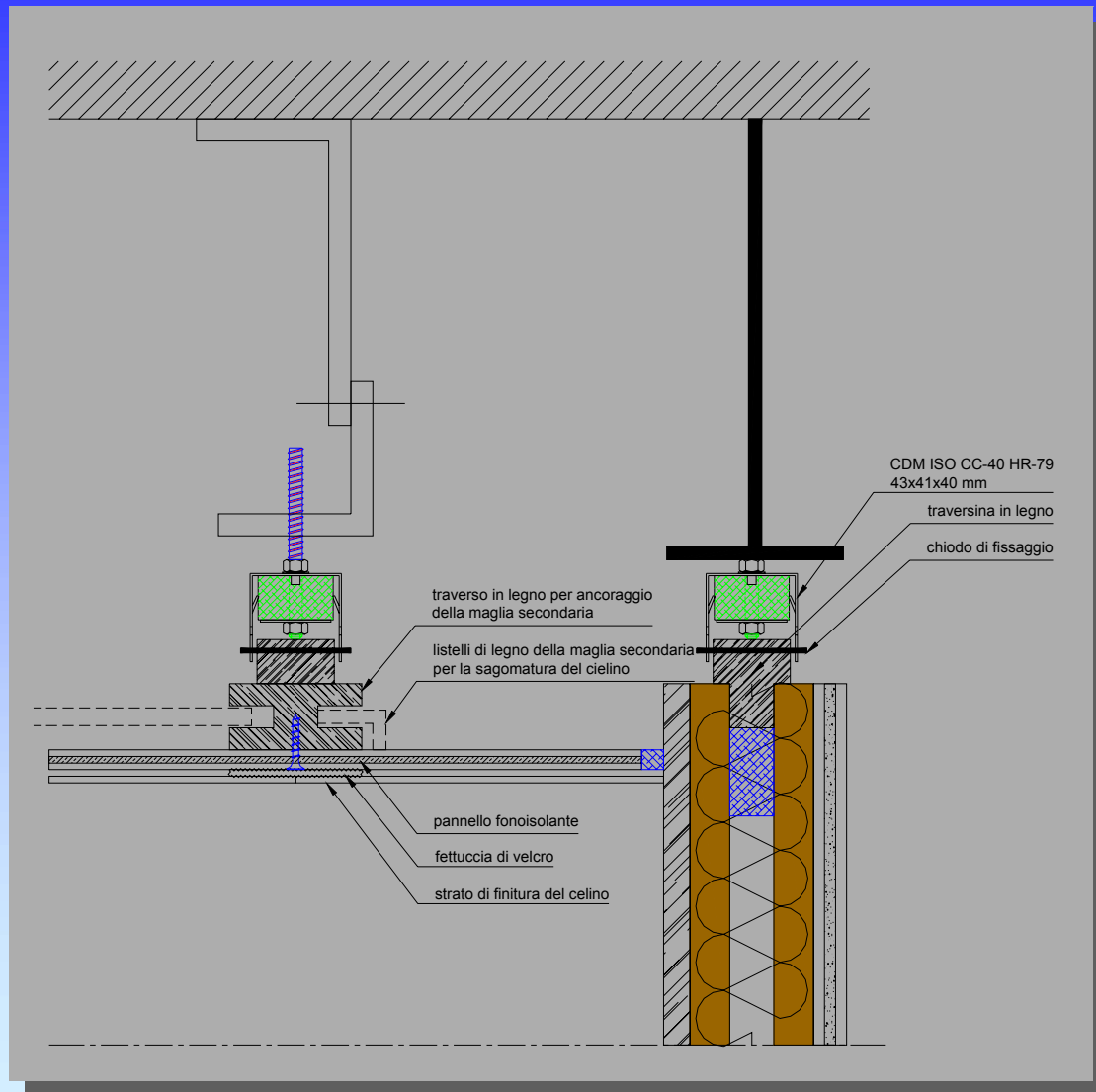

NEW YORK LADY: main solution

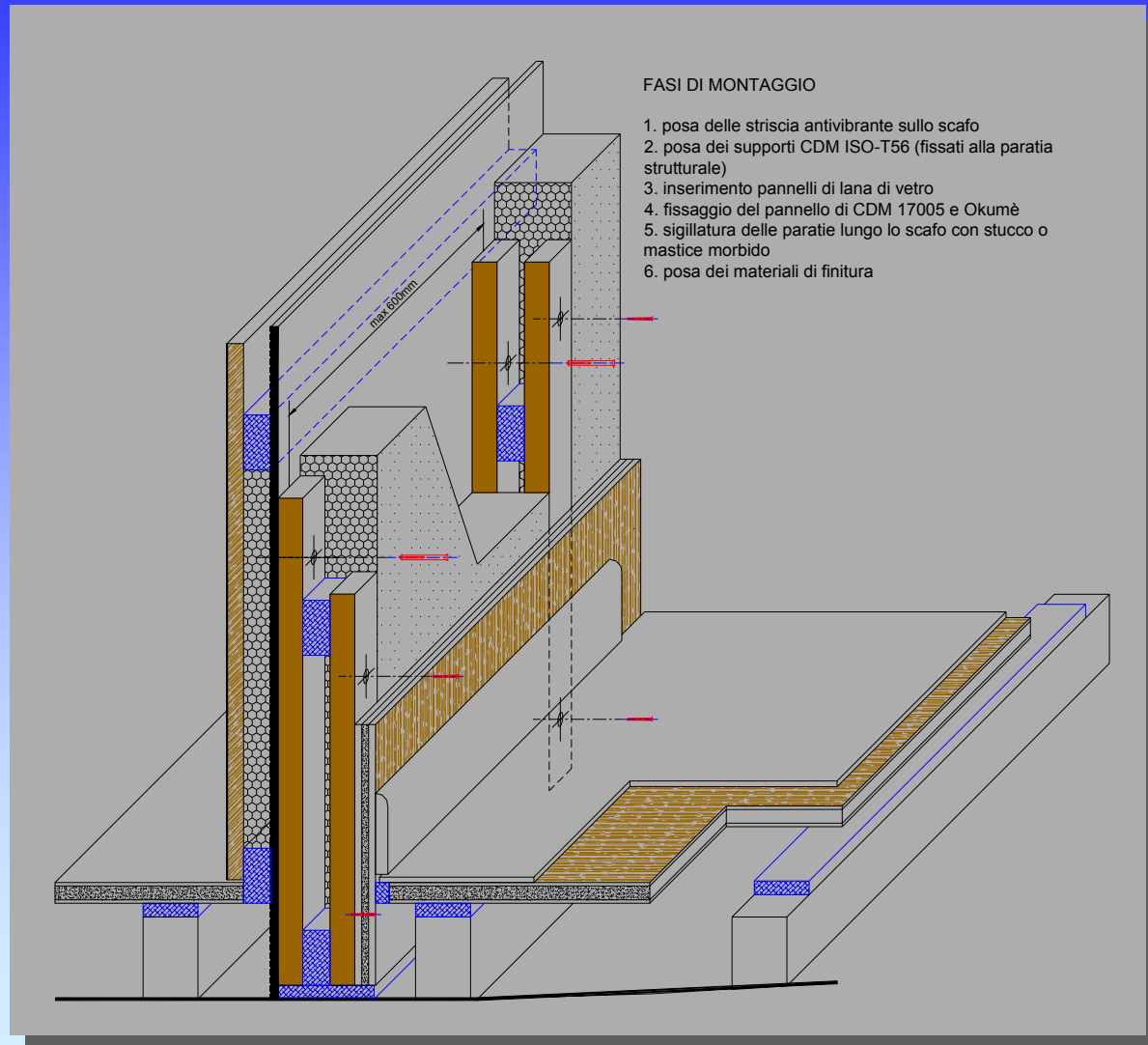

NEW YORK LADY: working progress



SOUND ISOLATION

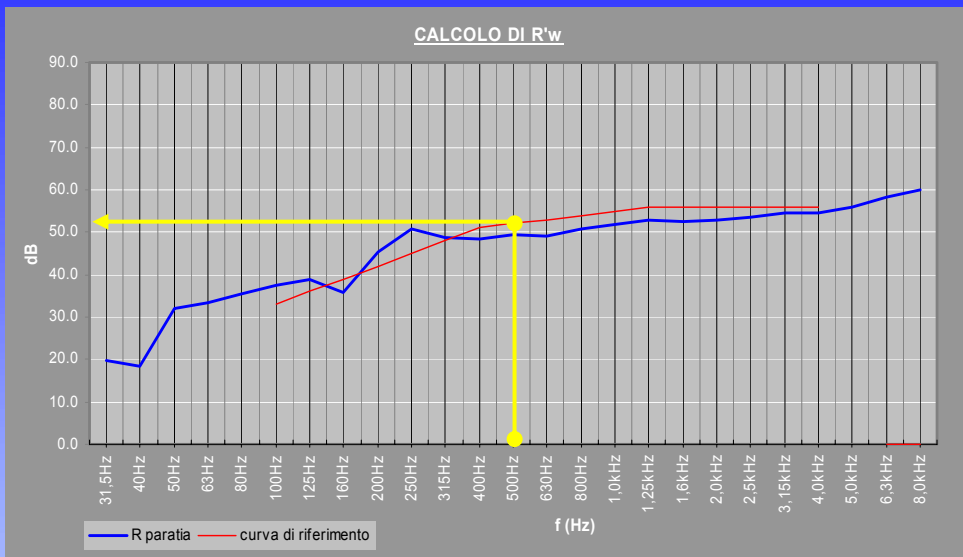

$R'w = 52 \text{ dB}$

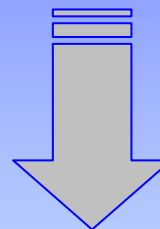

inside the cabin
55 < 66 dB(A)

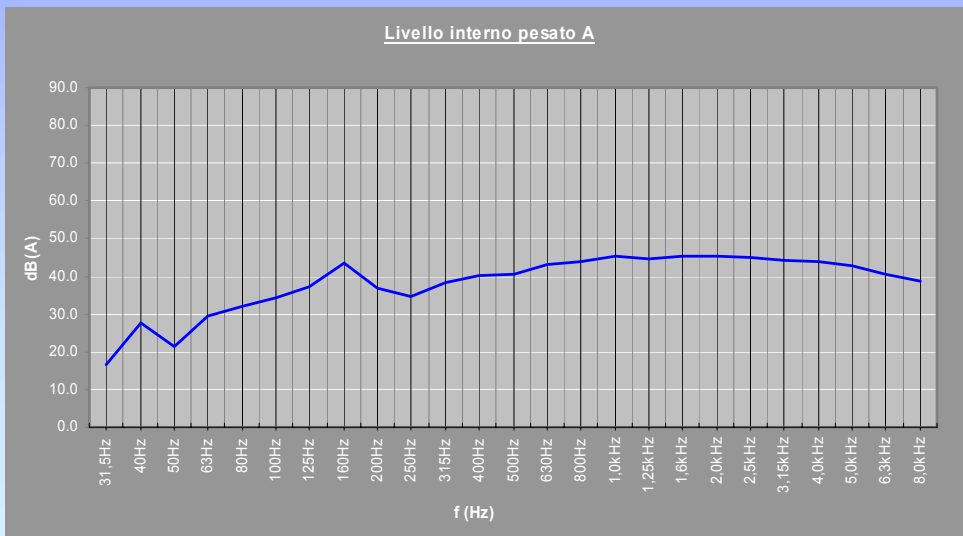

Frequency	Lp engine
31,5Hz	72.5
40Hz	78.0
50Hz	83.5
63Hz	89.0
80Hz	90.0
100Hz	91.0
125Hz	92.0
160Hz	92.7
200Hz	93.3
250Hz	94.0
315Hz	93.7
400Hz	93.3
500Hz	93.0
630Hz	94.3
800Hz	95.7
1,0kHz	97.0
1,25kHz	97.0
1,6kHz	97.0
2,0kHz	97.0
2,5kHz	97.2
3,15kHz	97.3
4,0kHz	97.5
5,0kHz	98.3
6,3kHz	99.2
8,0kHz	100.0